

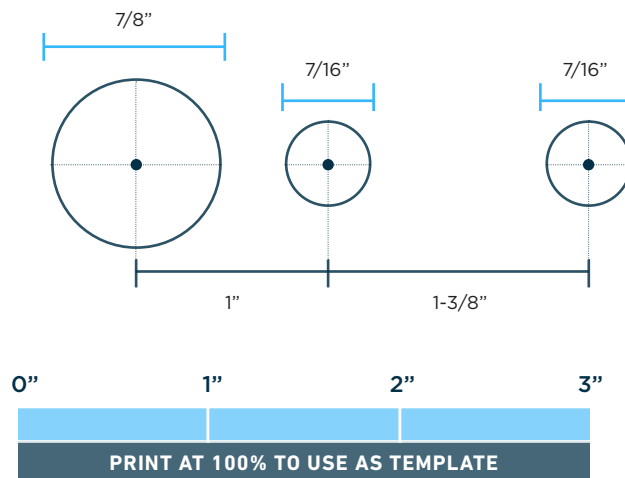

## Interactive Kiosk™ Table Stand for 12.9-inch iPad (Gen 3)

## STEP ONE: PREPARE YOUR TABLE

Drill mounting and cable access holes using a 7/8" and 7/16" drill at the desired location on the table surface. Refer to the spacing template.

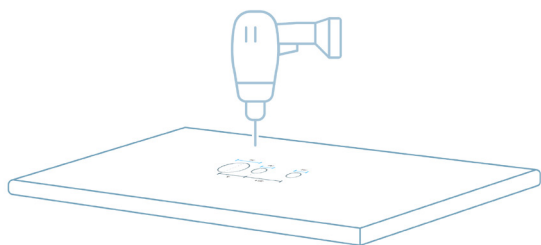

## STEP TWO: MOUNT THE TABLE STAND

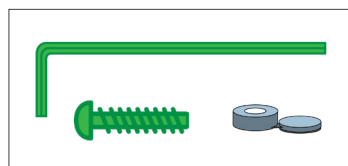
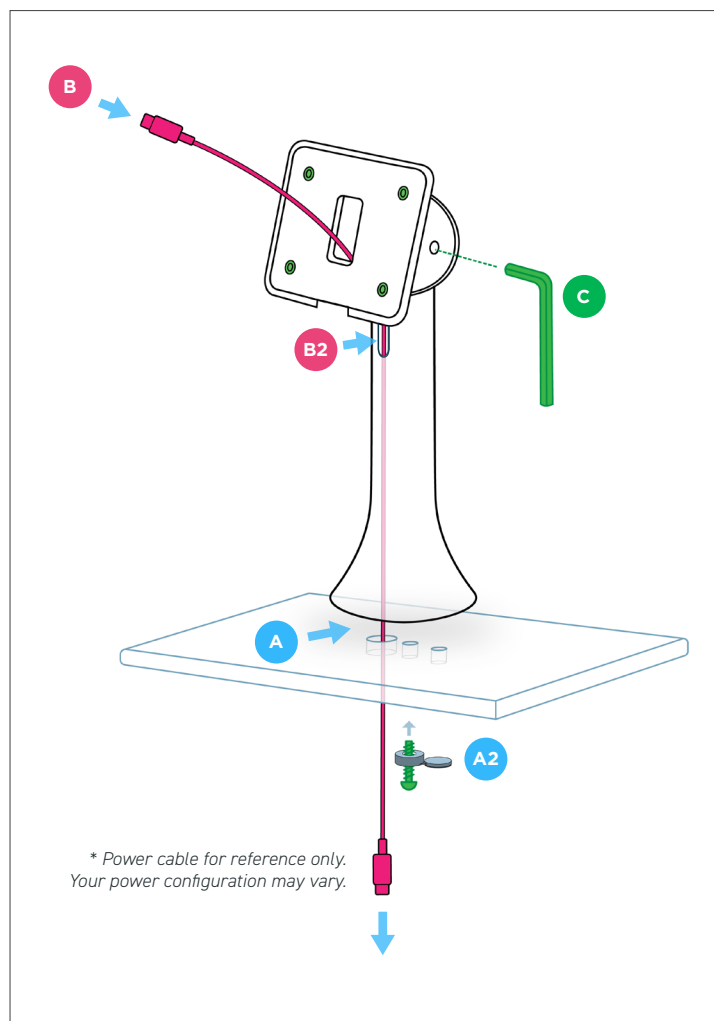

## SUPPLIED HARDWARE

- 5" long Hex Key
- 3/8" Pan Head Screw
- Snap Cover

- A.** Position the stand, and fasten with the supplied screw and snap cover (**A2**).
  - B.** Route the supplied USB cable through the top opening, leaving 8" of free length at the top, and press the cable into the strain relief slot (**B2**).
  - C.** Set the viewing angle with the supplied hex key.
-  **STOP HERE** and go to “2. ACCESSORIES” if you have a peripheral to connect. Otherwise, continue to STEP THREE.

### STEP THREE: ATTACH HEAD UNIT TO TABLE STAND

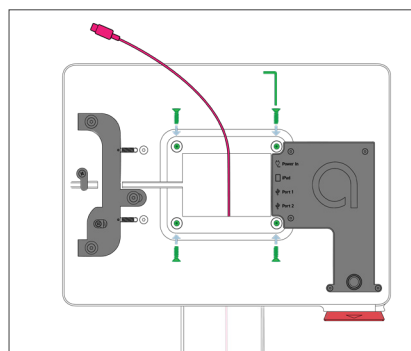

## SUPPLIED HARDWARE

- 2-1/2" long Hex Key
- 4x Flat Head Screw

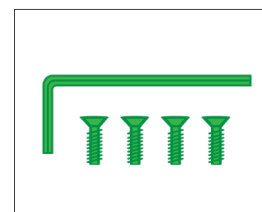



# Interactive Kiosk™ Wall Mount for 12.9-inch iPad (Gen 3)

## STEP ONE: DETERMINE MOUNTING HEIGHT AND LOCATION

Level the mount or template at the desired location on the wall, and mark the hole locations. Drill a pilot hole at each location and secure Wall Mount with supplied fasteners\*.

### SUPPLIED FASTENERS

- 4x Phillips Wood Screw
- 2x Snap Cover
- 4x #10 Toggle Bolt

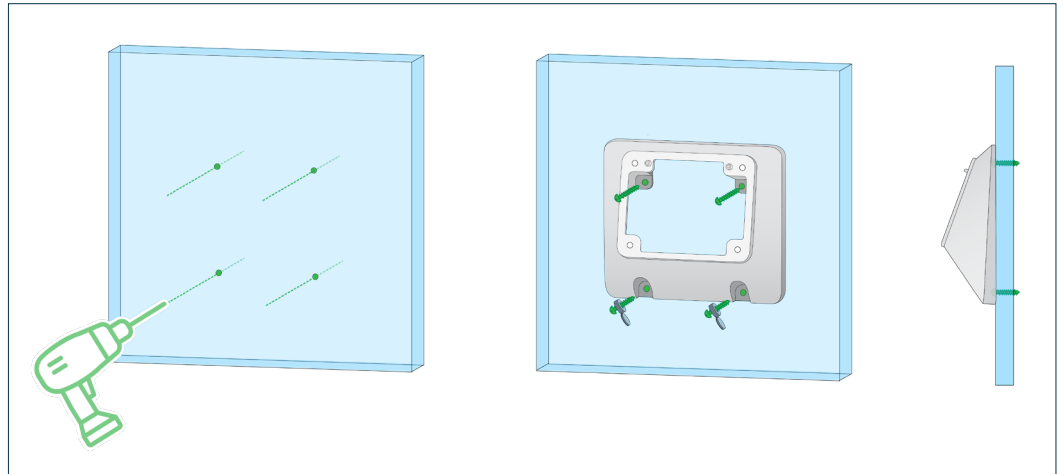
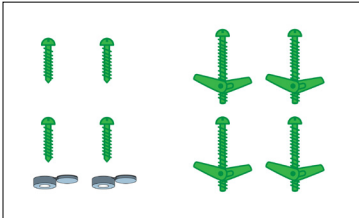

\*Aila provides hardware for securing to studs and drywall. For all other surfaces, choose an appropriate #10 fastener.

For information on how to install toggle bolts, [click here and visit: https://bit.ly/2KX0zcQ](https://bit.ly/2KX0zcQ)

## STOP: PREPARE FOR POWER

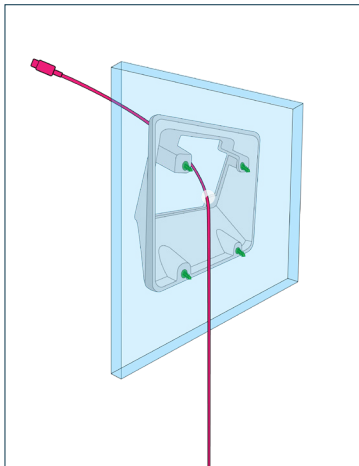

Route the supplied USB cable through your power openings. Your power openings are specific to your site.

**⚠ STOP HERE** and go to “2. ACCESSORIES” if you have a peripheral. Otherwise, continue to STEP TWO.

## STEP TWO: MOUNT THE HEAD UNIT

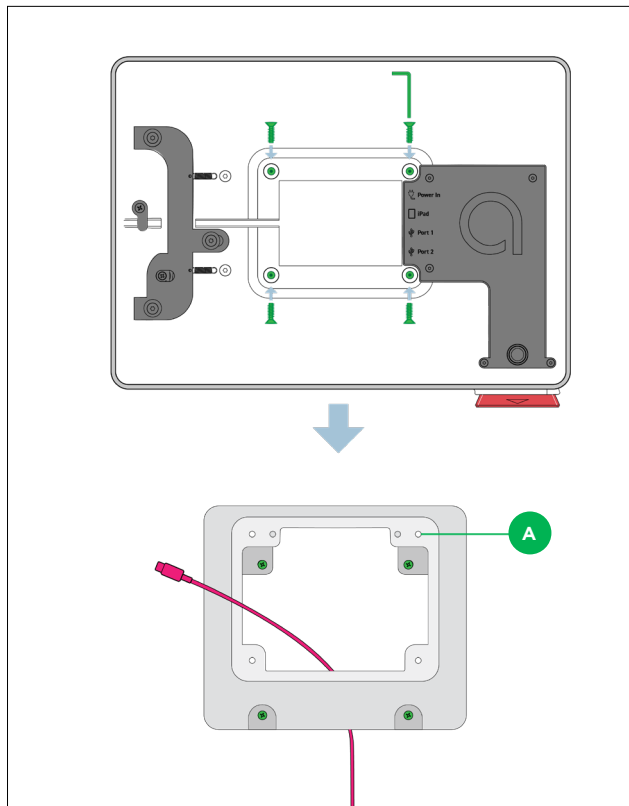

Orient the Kiosk enclosure with the Kiosk mounting holes (A), and fasten it with the supplied wrench and flat head screws.

### SUPPLIED HARDWARE

- 2-1/2" long Hex Key
- 4x Pan Head Screw

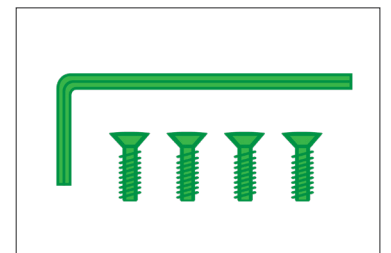



# Interactive Kiosk™ Wall Mount for 12.9-inch iPad (Gen 3)

## WALL MOUNT HOLE PATTERN TEMPLATE - SCALE 1:1

Print template at 100% and place the template at the desired height and location on the wall.

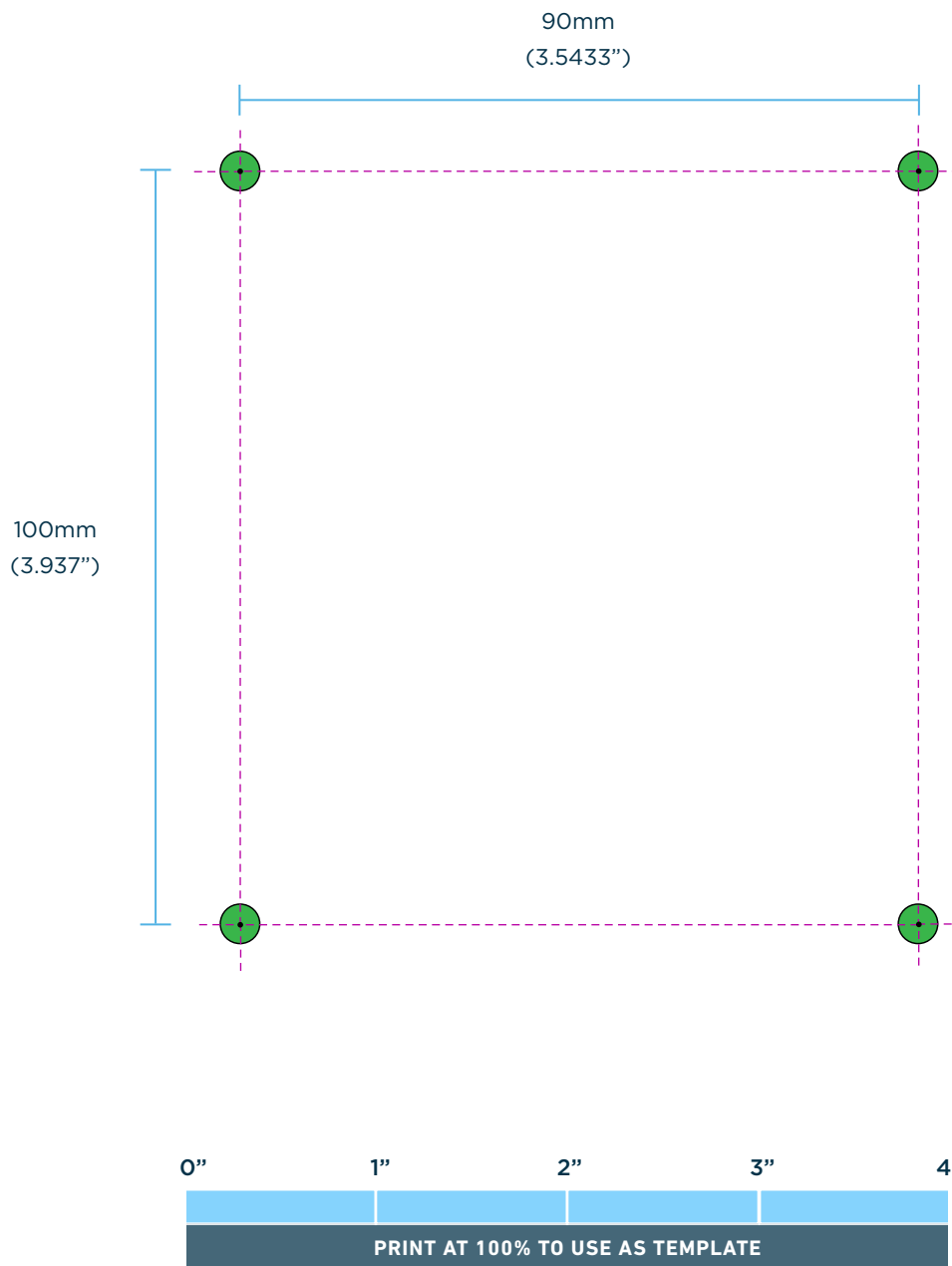



# Interactive Kiosk™ Freestanding Base for 12.9-inch iPad (Gen 3)

## STEP ONE: MOUNT THE TABLE STAND TO THE ACRYLIC BASE

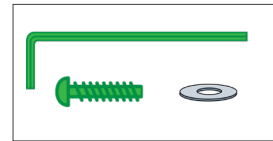
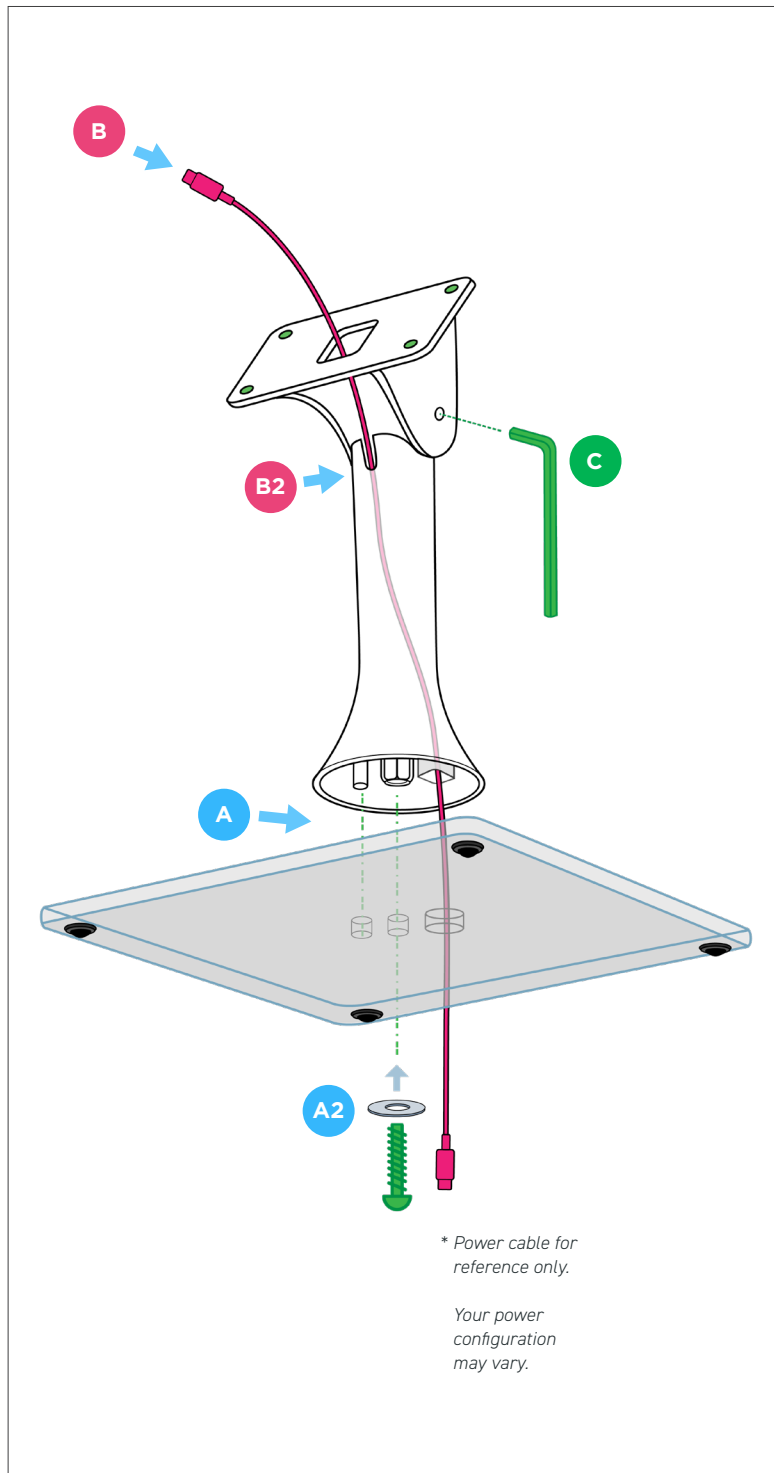

### SUPPLIED HARDWARE

- 2-1/2" long Hex Key
- 3/8" Button Head Hex Screw
- Steel Oversized Washer

- A.** Position the stand on the acrylic base, and fasten with the supplied screw and washer (A2).

**Assembly Note:** Tighten the button head screw finger tight + 1/2 revolution to avoid acrylic cracking.

- B.** Route the supplied USB cable through the top opening, leaving 8" of free length at the top, and press the cable into the strain relief slot (B2).

- C.** Set the viewing angle with the supplied hex key.

**STOP HERE** and go to "2. ACCESSORIES" if you have a peripheral to connect. Otherwise, continue to STEP THREE.

## STEP TWO: ATTACH HEAD UNIT TO TABLE STAND

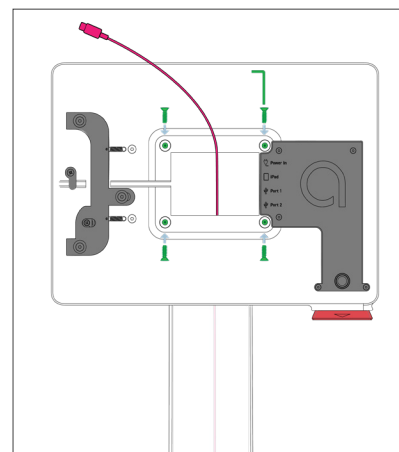

### SUPPLIED HARDWARE

- 2-1/2" long Hex Key
- 4x Flat Head Screw

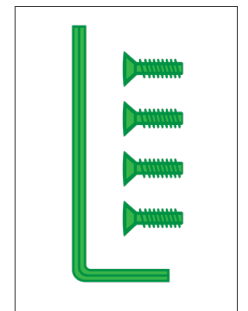



# Interactive Kiosk™ Payment Cradle for Ingenico iSMP4

## STEP ONE: INSTALL POWER CABLE

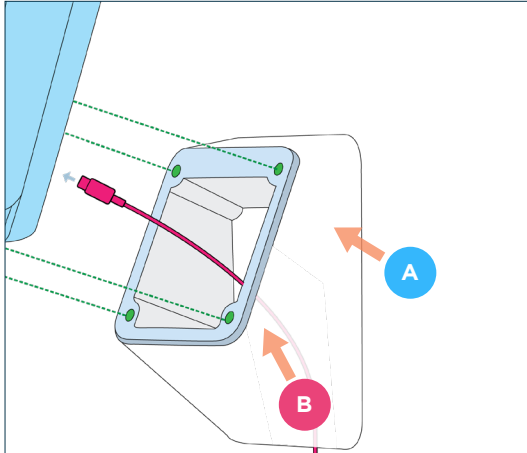

Plug the Micro-USB end of the supplied power cable into socket (A) on the payment cradle.

Route the cable through guide (B).

## STEP TWO: DETERMINE YOUR HARDWARE

### SUPPLIED HARDWARE

- 2-1/2" long Hex Key
- 4x 3/4" Flat Head Screw - For use with Aila Table Mount and VESA Mount
- 4x 7/8" Flat Head Screw - For use with Aila Floor Mount and Quick Disconnect

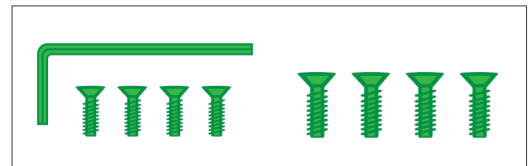

## STEP THREE: FASTEN KIOSK AND CRADLE TO MOUNT

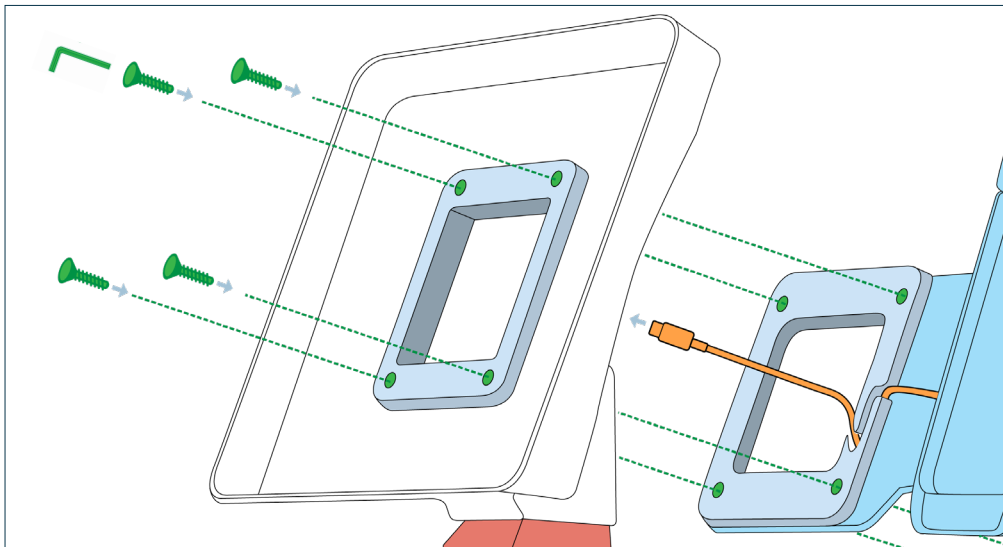

Fasten the Interactive Kiosk and the payment cradle to the mount using the supplied flat head screws.

- Mount shown for illustrative purposes only.
- Above hardware to be used in place of hardware supplied with your mount.

## STEP FOUR: SECURE THE PAYMENT DEVICE TO THE CRADLE

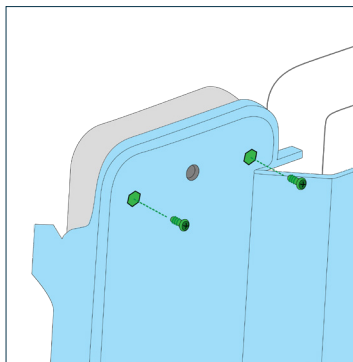
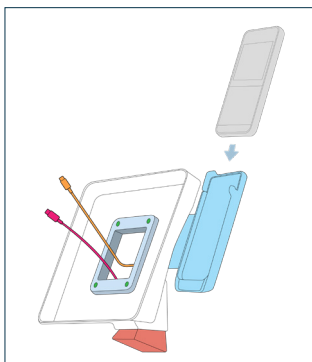

Slide the payment device as shown, and secure via the (4) included screws.

### SUPPLIED HARDWARE

- 4x Phillips Head Screw

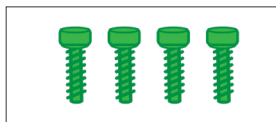

## NEXT: CONTINUE TO POWER >>

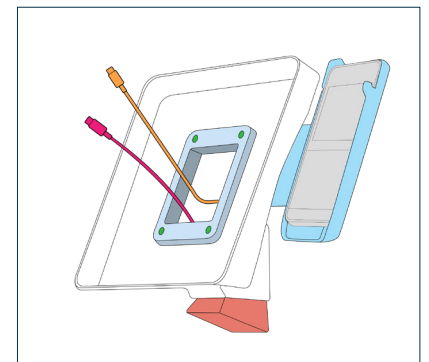



# Interactive Kiosk™ Payment Cradle for Verifone e355

## STEP ONE: INSTALL POWER CABLE

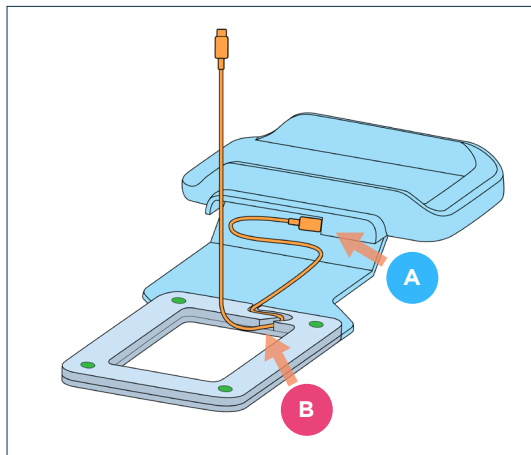

Plug the Micro-USB end of the supplied power cable into socket (A) on the payment cradle.

Route the cable through guide (B).

## STEP TWO: DETERMINE YOUR HARDWARE

### SUPPLIED HARDWARE

- 2-1/2" long Hex Key
- 4x 3/4" Flat Head Screw - For use with Aila Table Mount and VESA Mount
- 4x 7/8" Flat Head Screw - For use with Aila Floor Mount and Quick Disconnect

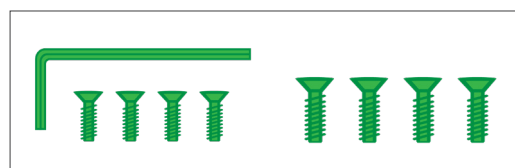

## STEP THREE: FASTEN KIOSK AND CRADLE TO MOUNT

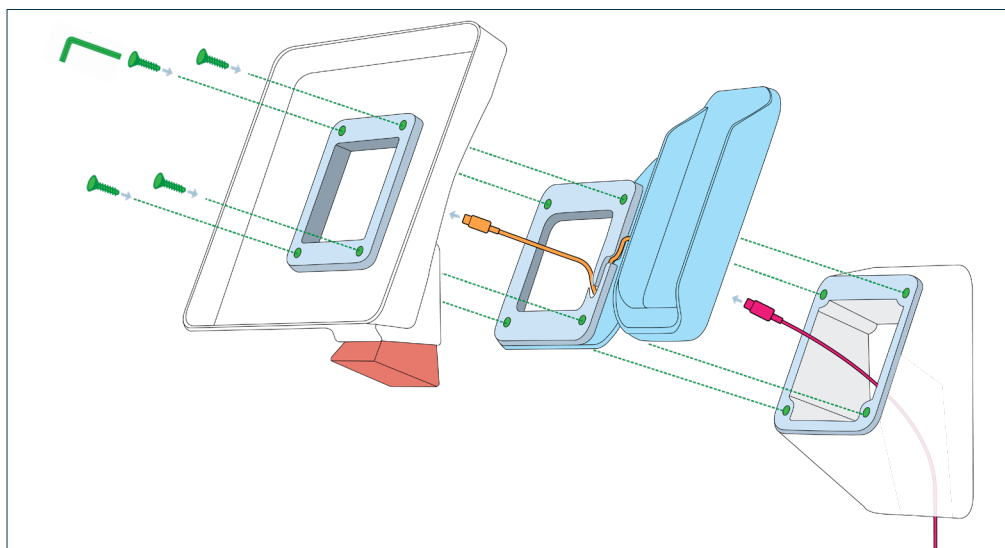

Fasten the Interactive Kiosk and the payment cradle to the mount using the supplied flat head screws.

- Mount shown for illustrative purposes only.
- Above hardware to be used in place of hardware supplied with your mount.

## STEP FOUR: SECURE THE PAYMENT DEVICE TO THE CRADLE

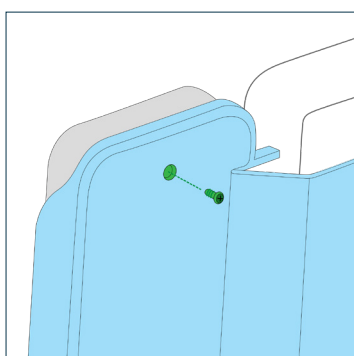
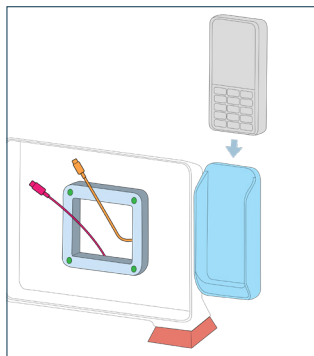

Slide the payment device as shown, and secure via the included screw.

### SUPPLIED HARDWARE

- 1x Phillips Head Screw

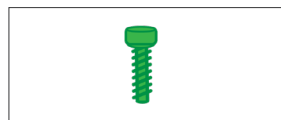

## NEXT: CONTINUE TO POWER >>

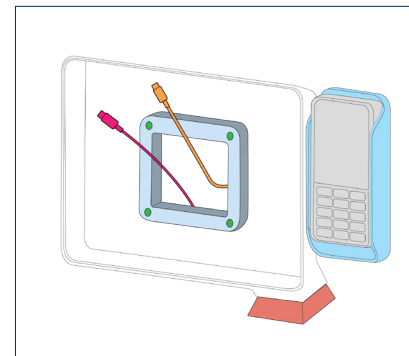



# Interactive Kiosk™ 12.9-inch iPad (Gen 3)

## 1. GET STARTED

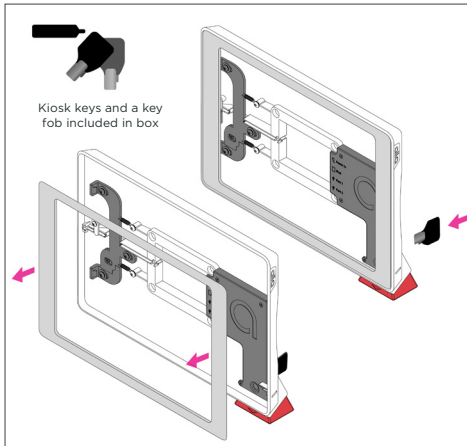

On the back of the unit, insert the kiosk key into the barrel lock and twist to unlock the front panel. Remove the faceplate from the kiosk by pulling the left side of the plate first, and then unhooking the right side. Remove the kiosk key from the back of the kiosk.

## 2. CONNECT THE CABLES

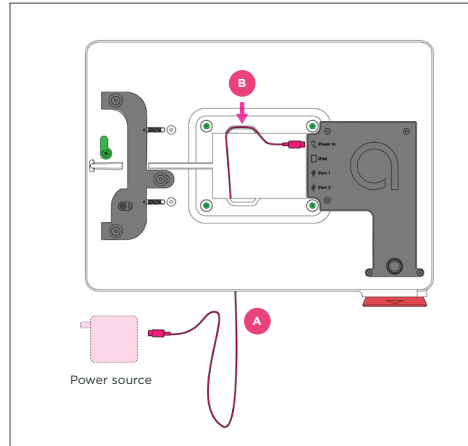

**A.** Feed the provided Anker USB-C power cable through the kiosk and plug it into a power source. **B.** Route the Anker USB-C power cable through the cable paths and plug it into the port labeled "Power In."

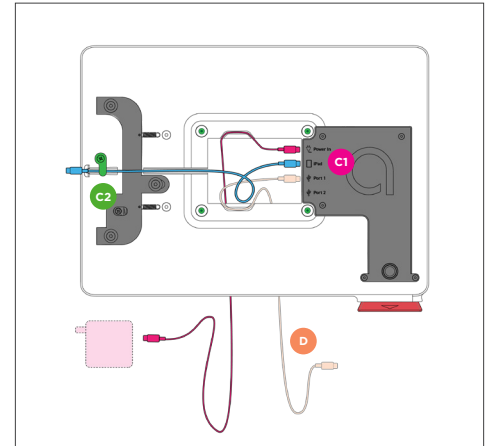

**C1.** Plug the Apple-provided USB-C cable into the port labeled "iPad." **C2.** Secure the other end of the Apple-provided USB-C cable along the left-side cable path and beneath the strain release (small black tab). Close the strain release, securing the cable (shown in green). **D.** If you have accessories, use **Port 1 & 2**. Secure your cable(s) with the bottom cable path.

## 3. CONNECT THE iPad

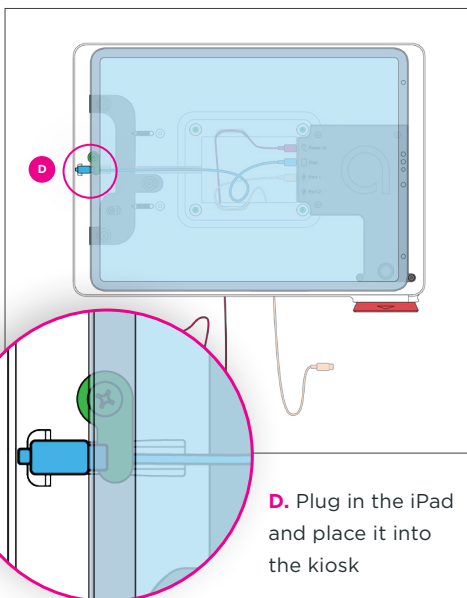

**DETAIL:** Apple USB-C plug flips up and over to fit flush between the iPad and Kiosk wall.

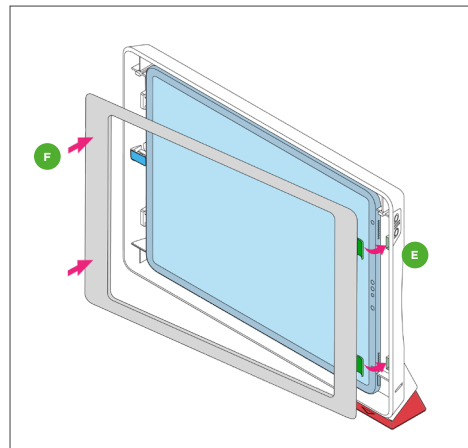

**E.** Reattach the faceplate right (or "hooked") side first. Slide the tabs into the enclosure, and firmly press down on the left edge (**F**) to fully engage the latch. **TIP:** be sure to remove the kiosk key from the back of the kiosk before securing the faceplate.

## 4. POWER UP

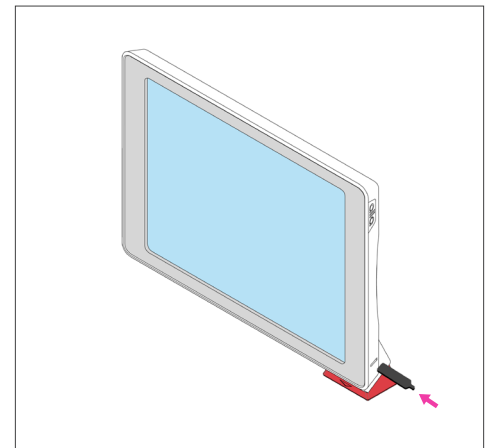

To power-on the iPad, use the provided access key fob to press the power button on the lower right side of the kiosk.